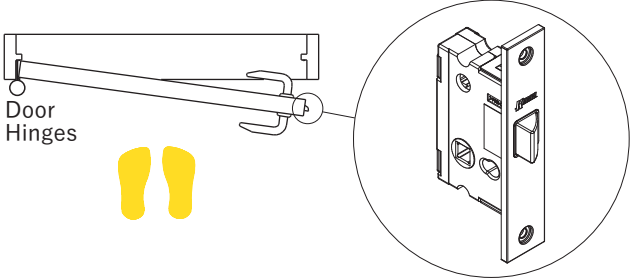
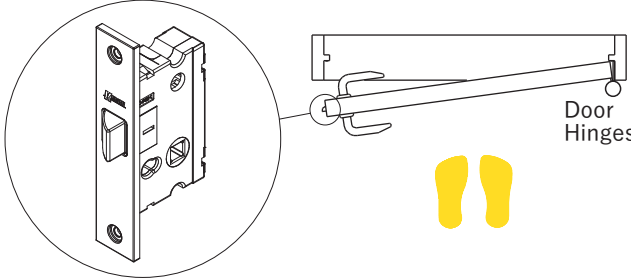

Explanation of Right-Hand and Left-Hand

Kuriki Standard

We determine the right-hand or left-hand door by standing in the side of the door where you can see the hinges. If they are on your right side, then it is a right-hand door. Meanwhile, if they are on your left side, then it is a left-hand door.

	
Left-Hand	Right-Hand

Example (Foreign Countries)

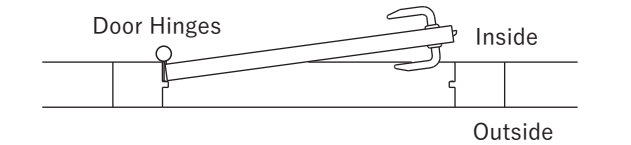
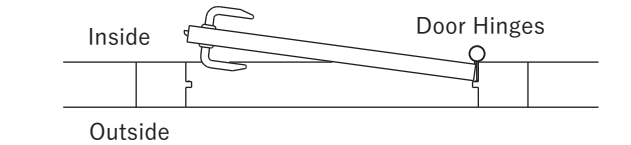
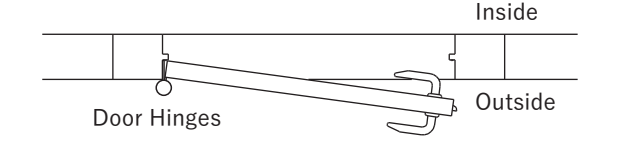
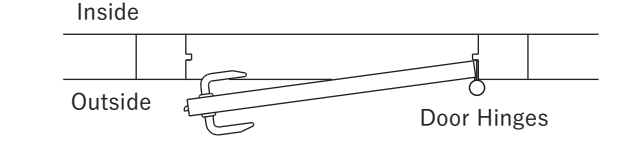
	
Left Hand	Right Hand
	
Left Hand Reverse	Right Hand Reverse

Aquila Type 01



This lever comes with a column shape that gives to the handle a symmetrical and elegant look. The grip part is designed with a perfect diameter to create comfort and safety.

Material: Aluminum
Standard Finish: SW·SA·SG·SB·CR·PG·AS·AA·AG
Customizable Finish: PC·CG·BC·SPC·SCG·SBC
Door Thickness: 28~40mm

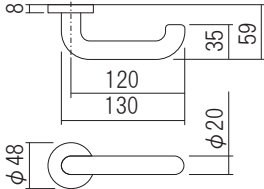

1M-CR



3M-CR



2E-SW

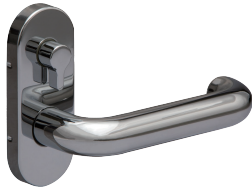

2J-CR

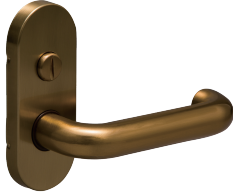

2C-SG

Crux Type 02



This lever has a beautiful, slim streamline design and a comfortable grip to give a perfect little touch to your room.

Material: Aluminum
Standard Finish: SW·SA·SG·SB·CR·PG
Customizable Finish: PC·CG·BC·SPC·SCG·SBC
Door Thickness: 28~40mm

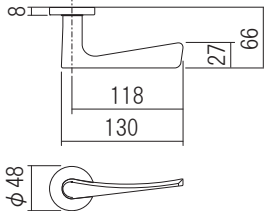

1M-SW



3C-CR



2C-CR



2F-CR



2C-SG